

# Location Plan

DC/02/00564/FUL

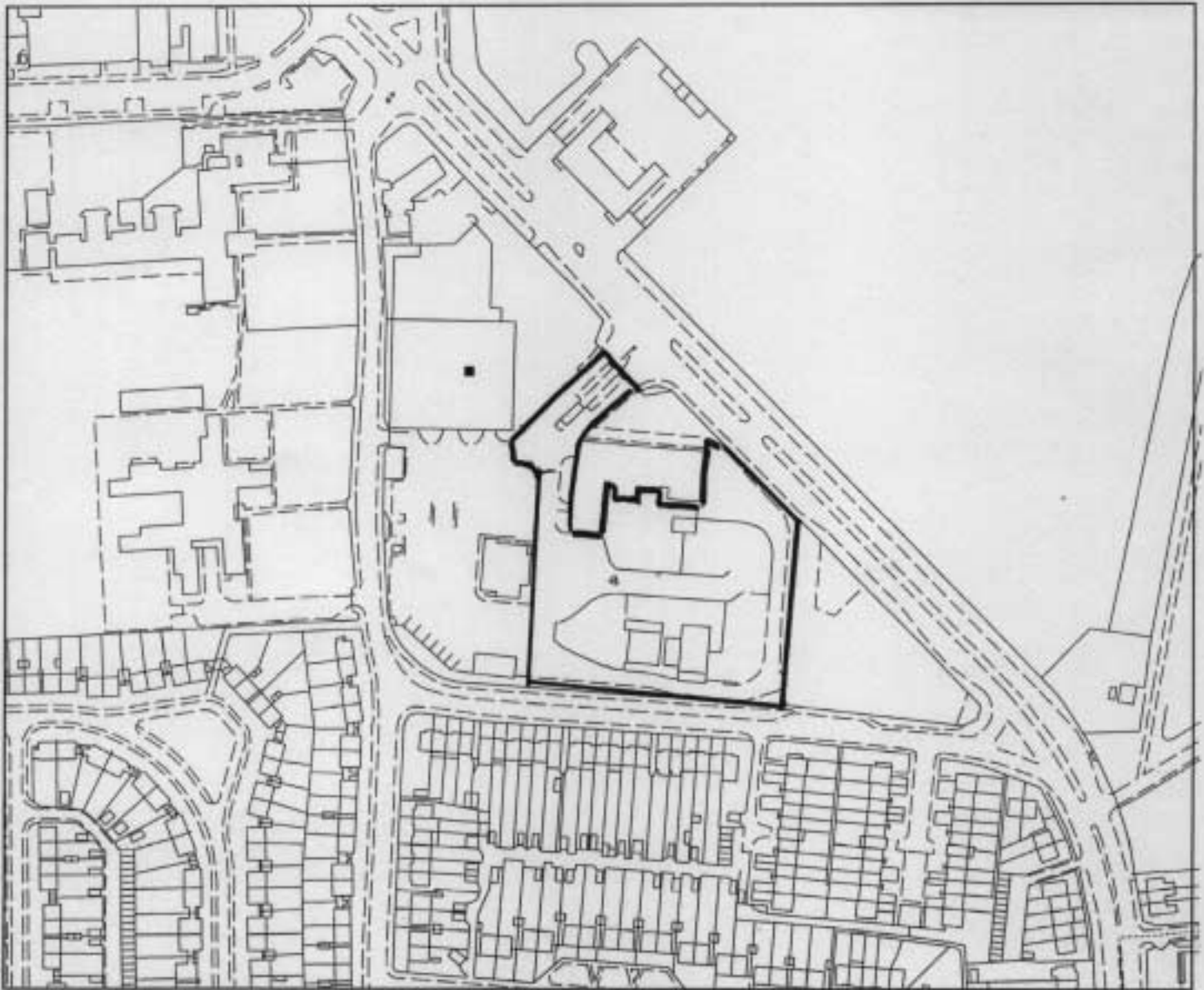

### Legend

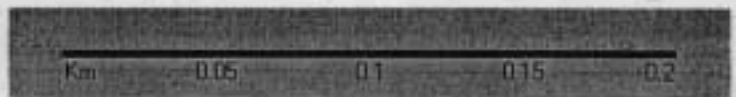

Reproduced from the Ordnance Survey map with the permission of the Controller of Her Majesty's Stationery Office © Crown Copyright 2000.

Unauthorised reproduction infringes Crown Copyright and may lead to prosecution or civil proceedings.

<b>Organisation</b>	London Borough of Barking and Dagenham
<b>Department</b>	LES
<b>Comments</b>	Not Set
<b>Date</b>	22 November 2002
<b>SLA Number</b>	